

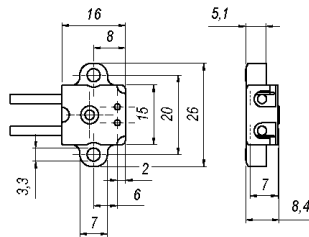

990

**G4
GY4
GZ4**



Lampholder with side contact

In order to allow a close positioning of the lamp to the reflector, the contact is located at the edge of the lampholder.

technical data

rated voltage: 50 V
 impulse category: II
 rated current: 10 A
 rated temperature: T350
 shock protection: unenclosed
 insulation: basic insulation

connection

standard wire:
 wire length:
 within the lampholder:

silicon
 145 mm
 9 mm

fixing

standard fixing:
 with screw M3

